

FAG

**20311-TVP**

Barrel roller bearing

Schaeffler ID:  
0167021310000Barrel roller bearings 203, main  
dimensions to DIN 635-1

## Technical information

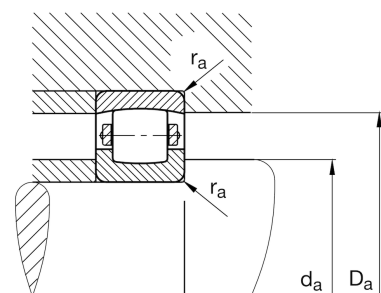
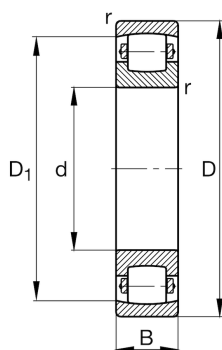
**Main Dimensions & Performance Data**

d	55 mm	Bore diameter
D	120 mm	Outside diameter
B	29 mm	Width
$C_r$	120,000 N	Basic dynamic load rating, radial
$C_{0r}$	138,000 N	Basic static load rating, radial
$C_{ur}$	12,600 N	Fatigue load limit, radial
$n_G$	5,400 1/min	Limiting speed
	1.57 kg	Weight

**Dimensions**

$r_{min}$	2 mm	Minimum chamfer dimension
$D_1$	101.7 mm	Bore diameter outer ring

**Mounting dimensions**

$d_{a min}$	66 mm	Minimum diameter shaft shoulder
$D_{a max}$	109 mm	Maximum diameter of housing shoulder
$r_{a max}$	2 mm	Maximum recess radius

**Temperature range**

$T_{min}$	-30 °C	Operating temperature min.
$T_{max}$	120 °C	Operating temperature max.